

INTERNATIONAL



SPLASHPROOF AND WATERTIGHT WIRING DEVICES



© 2004 International Configurations, Inc. Entire contents of this catalog copyrighted. www.InternationalConfig.com

International Configurations, Inc. • P.O. Box 3374 • Enfield, Connecticut 06083 • TEL (860) 749-6380 • FAX (860) 749-2985 89

SPLASHPROOF (IP 44 / IP 54) RECEPTACLES 2 POLE 3 WIRE GROUNDING TYPE



European
"Schuko" Type



NEMA 5-15R Type

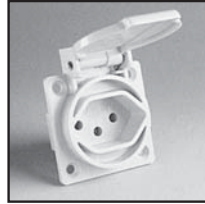

Swiss Type

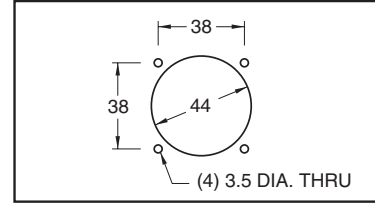

Panel cutout - common to all
receptacles listed in the table below

CATALOG NUMBER	RECEPTACLE CONFIGURATION	DESCRIPTION	APPROVALS	
70020		NEMA 5-15R	NEMA 5-15R, 15 amp 125 volt, gray, IP 44	CSA, UL
70120		"Schuko" CEE-7	16 amp 250 volt, gray, IP 54	FI, KEMA, OVE, VDE
71120		France / Belgium	16 amp 250 volt, gray, IP 54	CEBEC
72120		United Kingdom	BS 1363, 13 amp 250 volt, gray, IP 44	
75520		Italy	CEI 23-16 / VII, 10 / 16 amp 250 volt, blue, IP 44	IMQ
76120		Switzerland	SEV 1011, 10 amp 250 volt, gray, IP 54	SEV
76520		Switzerland	Type T23, 16 amp 250 volt, gray, IP 54	SEV
78120		Danish	AFSNIT 107-2-01, 13 amp 250 volt, gray, IP 44	DEMKO



Catalog No. 97120
Stainless steel wall plate with gasket and mounting screws. Mounts above receptacles to standard American 2" x 4" flush wall and surface mount boxes.



Catalog No. 70125
Compact size surface mount wall box. Accepts all of the above splashproof receptacles **except Catalog numbers 72120 and 78120.**



Catalog No. 70127
Optional terminal shield back box. Designed for use with all of the above splashproof receptacles when panel mounted.

AUSTRALIAN SPLASHPROOF IP 44 RECEPTACLES (AS / NZS 3112 2000)



Nos. 74120 & 74520
Australian panel mount receptacles.

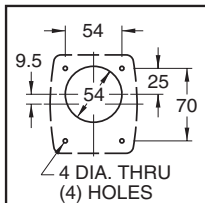

Panel cutout for Nos. 74120 and 74520



Nos. 74110 & 74510
Box mount receptacles for 2" x 4" American wall boxes.



Cat. No.	Description
74120	Panel mount, 10A 250V, white
74520	Panel mount, 15A 250V, white
74110	Wall box mount, 10A 250V, white
74510	Wall box mount, 15A 250V, white
79410	Weatherproof cover, gray. Fits Nos. 74110 and 74510 when mounted to 2" x 4" American wall box.



PRODUCT INSTALLATION GUIDE

SPLASHPROOF (IP 44 / IP 54) RECEPTACLES

PANEL MOUNTING

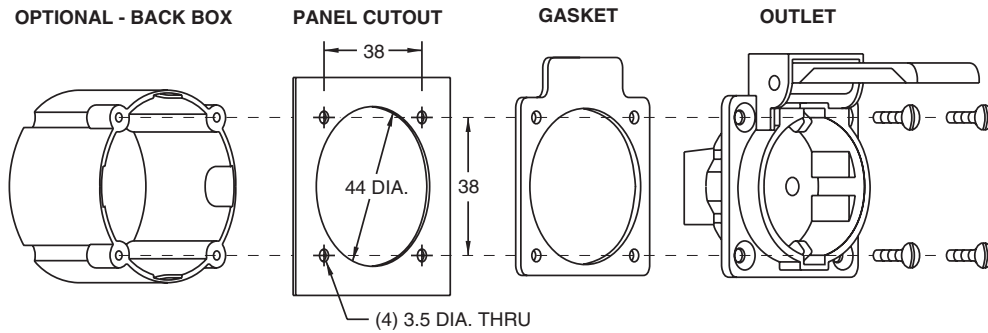

FLUSH & SURFACE MOUNTING TO 2" x 4" WALL BOXES

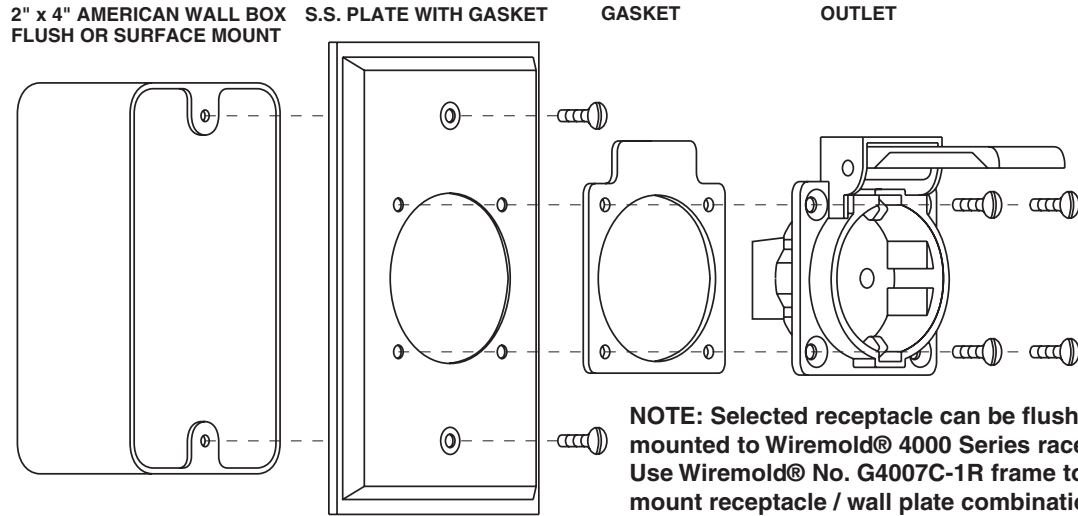

SURFACE MOUNT TO COMPACT WALL BOX

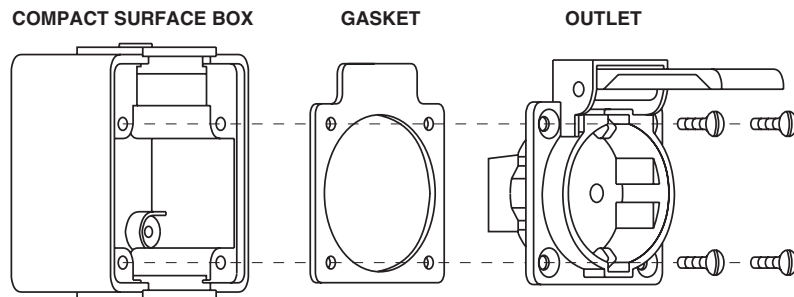

WATERTIGHT EUROPEAN "SCHUKO" WIRING DEVICES

2 Pole 3 Wire Grounding



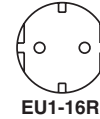

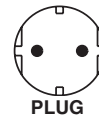

16 Ampere 250 Volt (CEE 7) DIN 49442 / 443, IP 68



EU1-16R

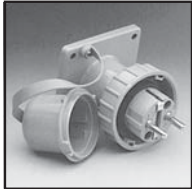

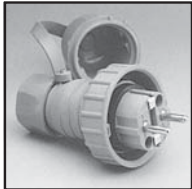
PLUG

		Cat. No.	Approvals	Drawing	Description
		70300	22	Pg. 234	European "SCHUKO" watertight single Receptacle. Blue. Screw mount small flange design with gasket.
70300	70310	70310	22	Pg. 234	
		70395	22	Pg. 235	European "SCHUKO" watertight inlet. Blue. Screw mount large flange design with gasket.
70395	70325	70325	N/A	Pg. 234	
		70325A	N/A	Pg. 234	Surface mount wall box for receptacle No. 70310 or inlet No. 70395. Blue. One cord inlet with strain relief.
70341		70341	22	Pg. 234	
		70341	22	Pg. 234	European "SCHUKO" watertight plug with closure cover. Blue.
70361		70361	22	Pg. 234	

Approvals: 1.ASTA 2.CEBEC 3.CSA 4.DEMKO 5.PSE(JET) 6.EANSW(DFT) 7.FI 8.GS 9.IMQ 10.JET 11.JIS 12.KEMA 13.NEMKO 14.OVE 15.SAA 16.SABS 17.SEMKO 18.SEV 19.SII 20.UL 21.UTE 22.VDE 23.ISO 24.CCC 25.IRAM 26.BSI

© 2004 International Configurations, Inc. Entire contents of this catalog copyrighted. www.InternationalConfig.com

