

**IEC 60309 - CEE 17**  
**IP 44 Splashproof Inlets**  
 Panel Mount, Straight Type

| VOLTAGE           | AMPS  | POLES       | GROUND POSITION | CATALOG NO. | DIMENSIONS |     |      |    |    |     |      |      | CLOSURE PLUG No. |         |
|-------------------|-------|-------------|-----------------|-------------|------------|-----|------|----|----|-----|------|------|------------------|---------|
|                   |       |             |                 |             | A          | B   | C    | D  | E  | F   | G    | K    |                  | L       |
| 100/130 V         | 16 A  | 2 P + E     | 4H              | 999-6134    | 70         | 70  | 41   | 56 | 56 | 5   | -    | 25   | 43               | 999-613 |
| 100/130 V         | 32 A  | 2 P + E     | 4H              | 999-6234    | 70         | 70  | 50   | 56 | 56 | 5   | -    | 30   | 55               | 999-623 |
| 100/130 V         | 63 A  | 2 P + E     |                 |             |            |     |      |    |    |     |      |      |                  |         |
| 100/130 V         | 125 A | 2 P + E     |                 |             |            |     |      |    |    |     |      |      |                  |         |
| 200/250 V         | 16 A  | 2 P + E     | 6H              | 999-6136    | 62         | 62  | 44   | 47 | 47 | 5.5 | 4.5  | 21.5 | 50               | 999-613 |
| 200/250 V         | 16 A  | 3 P + E     | 9H              | 999-6149    | 75         | 75  | 44   | 60 | 60 | 5.5 | 6.5  | 24.5 | 70               | 999-614 |
| 120/208-144/250 V | 16 A  | 3 P + N + E | 9H              | 999-6159    | 70         | 70  | 42   | 56 | 56 | 5   | -    | 26   | 54               | 999-615 |
| 200/250 V         | 32 A  | 2 P + E     | 6H              | 999-6236    | 75         | 75  | 53   | 60 | 60 | 5.5 | 6.5  | 27.5 | 70               | 999-623 |
| 200/250 V         | 32 A  | 3 P + E     | 9H              | 999-6249    | 75         | 75  | 53   | 60 | 60 | 5.5 | 6.5  | 27.5 | 70               | 999-623 |
| 120/208-144/250 V | 32 A  | 3 P + N + E | 9H              | 999-6259    | 70         | 70  | 50   | 56 | 56 | 5   | -    | 30   | 55               | 999-625 |
| 200/250 V         | 63 A  | 2 P + E     |                 |             |            |     |      |    |    |     |      |      |                  |         |
| 200/250 V         | 63 A  | 3 P + E     | 9H              | 999-14324   | 107        | 107 | 81.5 | 85 | 77 | 5.5 | 13.5 | 38   | 80               | 999-635 |
| 120/208-144/250 V | 63 A  | 3 P + N + E |                 |             |            |     |      |    |    |     |      |      |                  |         |
| 200/250 V         | 125 A | 2 P + E     |                 |             |            |     |      |    |    |     |      |      |                  |         |
| 200/250 V         | 125 A | 3 P + E     |                 |             |            |     |      |    |    |     |      |      |                  |         |
| 120/208-144/250 V | 125 A | 3 P + N + E |                 |             |            |     |      |    |    |     |      |      |                  |         |
| 380/415 V         | 16 A  | 2 P + E     | 9H              | 999-6139    | 70         | 70  | 41   | 56 | 56 | 5   | -    | 25   | 43               | 999-613 |
| 380/415 V         | 16 A  | 3 P + E     | 6H              | 999-6146    | 75         | 75  | 44   | 60 | 60 | 5.5 | 6.5  | 24.5 | 70               | 999-614 |
| 200/346-240/415 V | 16 A  | 3 P + N + E | 6H              | 999-7156    | 75         | 75  | 44   | 60 | 60 | 5.5 | 6.5  | 21.5 | 70               | 999-615 |
| 380/415 V         | 32 A  | 2 P + E     |                 |             |            |     |      |    |    |     |      |      |                  |         |
| 380/415 V         | 32 A  | 3 P + E     | 6H              | 999-6246    | 75         | 75  | 53   | 60 | 60 | 5.5 | 6.5  | 27.5 | 70               | 999-623 |
| 200/346-240/415 V | 32 A  | 3 P + N + E | 6H              | 999-6256    | 85         | 75  | 53   | 60 | 60 | 5.5 | 6.5  | 23.5 | 70               | 999-625 |
| 380/415 V         | 63 A  | 2 P + E     |                 |             |            |     |      |    |    |     |      |      |                  |         |
| 380/415 V         | 63 A  | 3 P + E     | 6H              | 999-14334   | 107        | 107 | 81.5 | 85 | 77 | 5.5 | 13.5 | 38   | 80               | 999-635 |
| 200/346-240/415 V | 63 A  | 3 P + N + E | 6H              | 999-15334   | 107        | 107 | 81.5 | 85 | 77 | 5.5 | 13.5 | 38   | 80               | 999-635 |
| 380/415 V         | 125 A | 2 P + E     |                 |             |            |     |      |    |    |     |      |      |                  |         |
| 380/415 V         | 125 A | 3 P + E     |                 |             |            |     |      |    |    |     |      |      |                  |         |
| 200/346-240/415 V | 125 A | 3 P + N + E |                 |             |            |     |      |    |    |     |      |      |                  |         |

All dimensions are in millimeters (1 mm = 0.039")

**NOTE:**  
 Locking tab not provided  
 for mating connectors

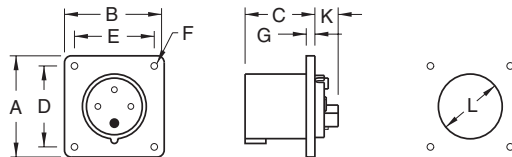

PANEL CUTOUT

© 2004 International Configurations, Inc. Entire contents of this catalog copyrighted. www.InternationalConfig.com

